

## CD 15 VRX

CEMENTING MACHINES



Robotized sole cementing machine with vision system for the automatic definition of gluing profiles



## CEMENTING

The gluing is carried out through an anthropomorphic robot able to work any type of sole (flat or boxed). The machine is designed to guarantee high productivity, working two soles simultaneously and loading and scanning the profile in masked time.



## SELF LEARNING

Self-learning of the profile and the conformation of the sole through 3D scanning that eliminates the need to program the gluing path.

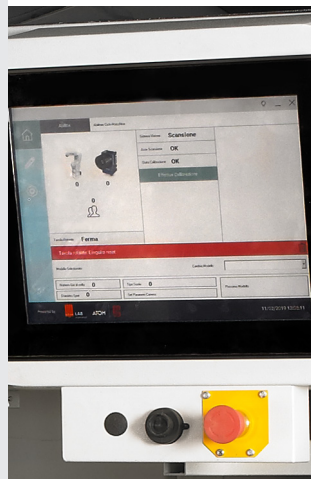

## ERGONOMIC SETTINGS

15 " touchscreen monitor, in an ergonomic position. Total integration between the machine and the robotic arm in order to guarantee maximum ease of use.



## REMOTE ASSISTANCE

Network connection for direct and immediate support to the customer. Easy updating of the machine software and easy identification of maintenance and processing problems.

## TECHNICAL DATA

MODELS	VOLTAGE (V)	MAX. ABSORPTION (kW)	AIR CONSUMPT. (NI/min)	NOISE EMISSION (dBA)	FREQUENCY (Hz)	SIZES (mm)	WEIGHT (Kg)
CD15 VRX	400 - 3Ph+PE	6	40	71	50/60	1265x1825x2090	1150

Subject to change without notice - February 2019 edition



AVANTIUM S.R.L.  
27029 Vigevano – Italy – Corso Novara, 218  
Tel. +39 0381 20905 – Telefax +39 0381 24358  
E-mai : [info@avantium.it](mailto:info@avantium.it) – web : [www.avantium.it](http://www.avantium.it)



ATOM

